

# 自編網頁講義(學習單 1)

**Places in The City**  
**Matching exercise**

Match the items on the right to the items on the left.

[Check](#)

You take a train here.	<input type="text" value="train station"/>
You pray for good luck here.	<input data-bbox="890 618 1018 645" type="text" value="???"/>
You get new books, toys, or office supplies here.	<input data-bbox="890 651 1018 678" type="text" value="???"/>
You study here.	<input data-bbox="890 685 1018 712" type="text" value="???"/>
You stay here when you travel.	<input data-bbox="890 719 1018 745" type="text" value="???"/>
You send post cards here.	<input data-bbox="890 752 1018 779" type="text" value="???"/>
You take a bus here.	<input data-bbox="890 786 1018 813" type="text" value="???"/>
You go shopping here.	<input data-bbox="890 819 1018 846" type="text" value="???"/>
You eat food here.	<input data-bbox="890 853 1018 880" type="text" value="???"/>
You come here when you are sick.	<input data-bbox="890 887 1018 913" type="text" value="???"/>
You watch movies here.	<input type="text" value="hospital"/>
You call 110 to people here for help.	<input data-bbox="890 949 1018 976" type="text" value="???"/>
You save or deposit money here.	<input data-bbox="890 983 1018 1010" type="text" value="???"/>
You call 119 to people here for help.	<input data-bbox="890 1016 1018 1043" type="text" value="???"/>
You can buy fish, chicken, and vegetables here.	<input data-bbox="890 1050 1018 1077" type="text" value="???"/>

[Index](#) =>

**Places in The City**  
**Matching exercise**

Match the items on the right to the items on the left.

[Check](#)

<input type="text" value="You take a train here."/>	<input type="text" value="temple"/>
<input type="text" value="You pray for good luck here."/>	<input type="text" value="department store"/>
<input type="text" value="You get new books, toys, or office supplies here."/>	<input type="text" value="hospital"/>
<input type="text" value="You study here."/>	<input type="text" value="train station"/>
<input type="text" value="You stay here when you travel."/>	<input type="text" value="fire station"/>
<input type="text" value="You send post cards here."/>	<input type="text" value="bookstore"/>
<input type="text" value="You take a bus here."/>	<input type="text" value="school"/>
<input type="text" value="You go shopping here."/>	<input type="text" value="police station"/>
<input type="text" value="You eat food here."/>	<input type="text" value="restaurant"/>
<input type="text" value="You come here when you are sick."/>	<input type="text" value="hotel"/>
<input type="text" value="You watch movies here."/>	<input type="text" value="bank"/>
<input type="text" value="You call 110 to people here for help."/>	<input type="text" value="post office"/>
<input type="text" value="You save or deposit money here."/>	<input type="text" value="supermarket"/>
<input type="text" value="You call 119 to people here for help."/>	<input type="text" value="movie theater"/>

# 學生個別作業

Places in The City

Match the items on the right to the items on the left.

Check

You take a train here.	hotel
You pray for good luck here.	hospital
You get new books, toys, or office supplies here.	supermarket
You study here.	bookstore
You stay here when you travel.	restaurant
You send post cards here.	police station
You take a bus here.	movie theater
You go shopping here.	department store
You eat food here.	school
You come here when you are sick.	fire station
You watch movies here.	post office
You call 110 to people here for help.	train station
You save or deposit money here.	temple
You call 119 to people here for help.	bus stop
You can buy fish, chicken, and vegetables here.	bank

Places in The City

Match the items on the right to the items on the left.

Check

You take a train here.	hotel
You pray for good luck here.	hospital
You get new books, toys, or office supplies here.	supermarket
You study here.	bookstore
You stay here when you travel.	restaurant
You send post cards here.	police station
You take a bus here.	movie theater
You go shopping here.	department store
You eat food here.	school
You come here when you are sick.	fire station
You watch movies here.	post office
You call 110 to people here for help.	train station
You save or deposit money here.	temple
You call 119 to people here for help.	bus stop
You can buy fish, chicken, and vegetables here.	bank

# 自編講義(學習單 2)

## Unit 5 How Do I Get to Big Ben?

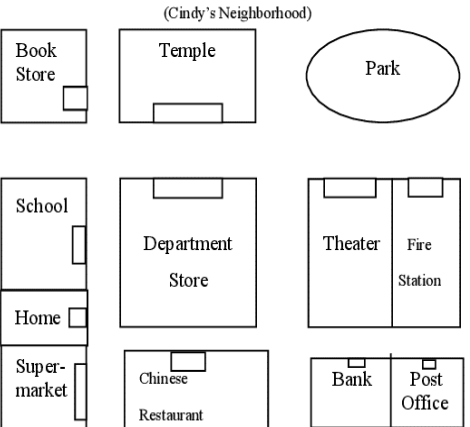
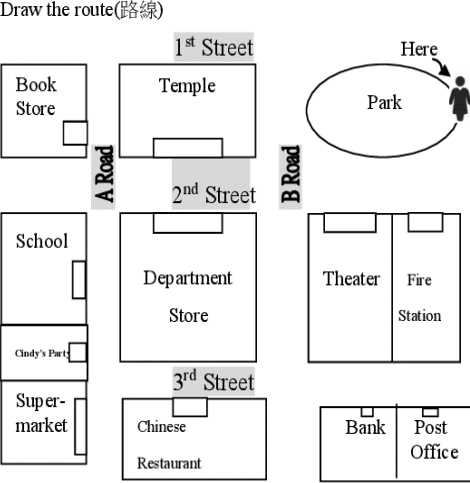
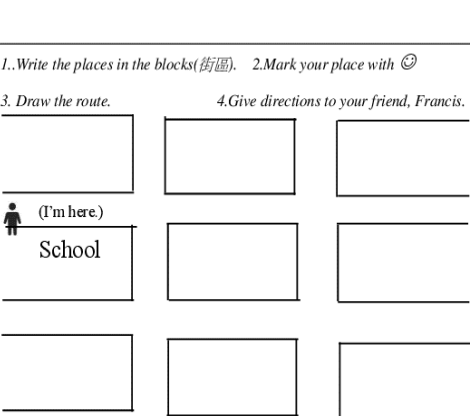
<p style="text-align: center;">(Cindy's Neighborhood)</p> 	<p>This is Cindy's neighborhood. It's nice and convenient.</p> <p>There is a big _____ store across from a _____. There's a bank in back of the _____. Next to the bank, there's a _____.</p> <p>In her neighborhood, there is a supermarket. Behind the supermarket, there is a school _____ the corner. Cindy's house is _____ the school and the supermarket. There is also a Chinese restaurant near Cindy's house. The food is great.</p> <p>Please come and visit her neighborhood.</p>
<p>Draw the route (路線)</p> 	<p>Now you're at the _____, and you're asking a man for directions. (You know Cindy's party is between the _____ and the school.)</p> <p>You: _____ me. _____ do I get to the school?</p> <p>Man: Turn left here and walk down <b>1<sup>st</sup> Street</b>. Go _____ for only one block. Then, turn _____ at the _____. Walk _____ <b>A Road</b>. Keep going _____. The school is on your _____.</p> <p>You can't miss it!</p> <p>You: Thank you very much.</p>
<p>1. Write the places in the blocks (街區).    2. Mark your place with ☺</p> <p>3. Draw the route.    4. Give directions to your friend, Francis.</p>  <p>(I'm here.) School</p>	<p>My friend, Francis is coming to see me at my place. He is asking me for directions.</p> <p>Francis: _____ your place?</p> <p>Me: _____ are you?</p> <p>Francis: I'm at the school.</p> <p>Me: _____</p> <p>_____</p> <p>_____</p>
<p>Go straight. ↑ / Turn right. ↻ / Turn left. ↶</p>	

## Unit 5 How Do I Get to Big Ben?

(Cindy's Neighborhood)

Book Store	Temple	Park
School	Department Store	Theater Fire Station
Home	Chinese Restaurant	Bank Post Office
Super-market		

This is Cindy's neighborhood. It's nice and convenient.  
 There is a big \_\_\_\_\_ store across from a \_\_\_\_\_. There's a bank in back of the \_\_\_\_\_. Next to the bank, there's a \_\_\_\_\_. In her neighborhood, there is a supermarket. Behind the supermarket, there is a school \_\_\_\_\_ the corner. Cindy's house is \_\_\_\_\_ the school and the supermarket. There is also a Chinese restaurant near Cindy's house. The food is great.  
 Please come and visit her neighborhood.

Draw the route(路線)

	1 <sup>st</sup> Street	
Book Store	Temple	Park
School	Department Store	Theater Fire Station
Cindy's Party	3 <sup>rd</sup> Street	Bank Post Office
Super-market	Chinese Restaurant	

Now you're at the \_\_\_\_\_, and you're asking a man for directions. (You know Cindy's party is between the \_\_\_\_\_ and the school.)  
 You: \_\_\_\_\_ me. \_\_\_\_\_ do I get to the school?  
 Man: Turn left here and walk down 1<sup>st</sup> Street. Go \_\_\_\_\_ for only one block. Then, turn \_\_\_\_\_ at the \_\_\_\_\_. Walk \_\_\_\_\_ A Road. Keep going \_\_\_\_\_. The school is on your \_\_\_\_\_.  
 You can't miss it!  
 You: Thank you very much.

1. Write the places in the blocks(街区). 2. Mark your place with ☺  
 3. Draw the route. 4. Give directions to your friend, Francis.

(I'm here.) School		

Go straight. ↑ / Turn right. ↻ / Turn left. ↶

My friend, Francis is coming to see me at my place. He is asking me for directions.  
 Francis: \_\_\_\_\_ your place?  
 Me: \_\_\_\_\_ are you?  
 Francis: I'm at the school.  
 Me: \_\_\_\_\_  
 \_\_\_\_\_  
 \_\_\_\_\_

# 學生個別作業\_原尺寸: B4

## Unit 5 How Do I Get to Big Ben? Number:          Name: 簡希萍

(Cindy's Neighborhood)

This is Cindy's neighborhood. It's nice and convenient.

There is a big department store across from a temple. There's a bank in back of the theater. Next to the bank, there's a post office. In her neighborhood, there is a supermarket. Behind the supermarket, there is a school on the corner. Cindy's house is between the school and the supermarket. There is also a Chinese restaurant near Cindy's house. The food is great.

Please come and visit her neighborhood. ✓

Draw the route (路線)

Now you're at the park, and you're asking a man for directions. (You know Cindy's party is between the supermarket and the school.)

You: Excuse me. How do I get to the school?

Man: Turn left here and walk down 1st Street. Go straight for only one block. Then, turn left at the temple. Walk down A Road. Keep going straight. The school is on your right.

You can't miss it!

You: Thank you very much. ✓

1. Write the places in the blocks (街區). 2. Mark your place with ⊙ ?  
3. Draw the route. 4. Give directions to your friend, Francis.

My friend, Francis is coming to see me at my place. He is asking me for directions.

Francis: How do I get your place?

Me: Where are you?

Francis: I'm at the school. ✓

Me: Go straight for one block and turn right at department store. Go along 2nd street for one block, It's on your right.

Go straight. ↑ / Turn right. ↘ / Turn left. ↙

Unit 5 How Do I Get to Big Ben? Number: 09 Name: 符允澤

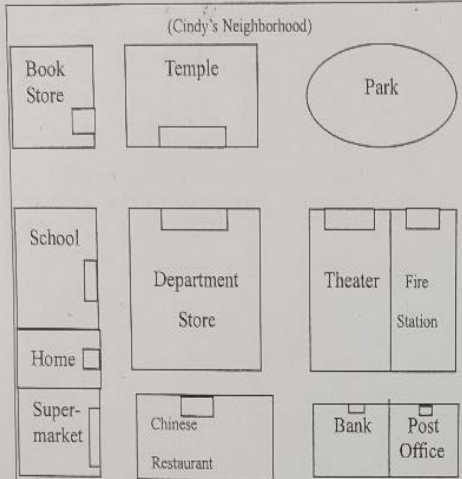

This is Cindy's neighborhood. It's nice and convenient.

There is a big department store across from a temple. There's a bank in back of the theater. Next to the bank, there's a post office. In her neighborhood, there is a supermarket. Behind the supermarket, there is a school on the corner. Cindy's house is between the school and the supermarket. There is also a Chinese restaurant near Cindy's house. The food is great.

Please come and visit her neighborhood. ✓

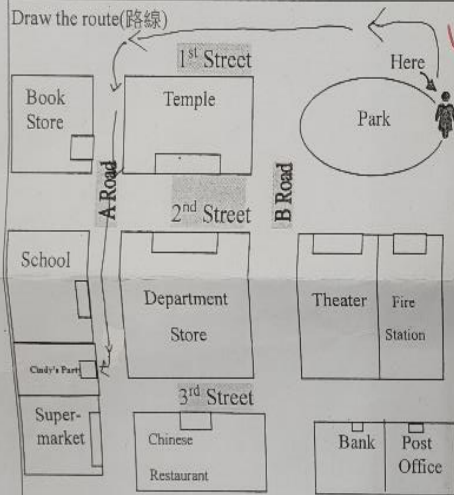

Now you're at the park, and you're asking a man for directions. (You know Cindy's party is between the super market and the school.)

You: Excuse me. How do I get to the school?

Man: Turn left here and walk down 1st Street. Go straight for only one block. Then, turn left at the temple. Walk down A Road. Keep going straight. The school is on your right.

You can't miss it!

You: Thank you very much. ✓

1. Write the places in the blocks (街區). 2. Mark your place with ⊙

3. Draw the route. 4. Give directions to your friend, Francis.

Go straight. ↑ / Turn right. ↗ / Turn left. ↖

My friend, Francis is coming to see me at my place. He is asking me for directions.

Francis: How do I get to your place?

Me: where are you?

Francis: I'm at the school. ✓

Me: Go straight for one block and turn right on 2nd street. Go along 2nd street for one block. It's on your right.

Unit 5 How Do I Get to Big Ben? Number: 5/ Name: 李超

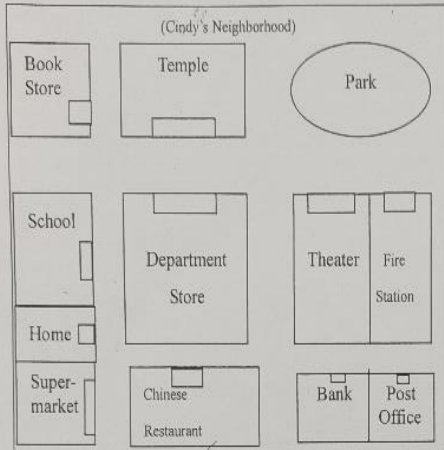

This is Cindy's neighborhood. It's nice and convenient.  
 There is a big department store across from a temple. There's a bank in back of the theater. Next to the bank, there's a post office. In her neighborhood, there is a supermarket. Behind the supermarket, there is a school on the corner. Cindy's house is between the school and the supermarket. There is also a Chinese restaurant near Cindy's house. The food is great.  
 Please come and visit her neighborhood. ✓

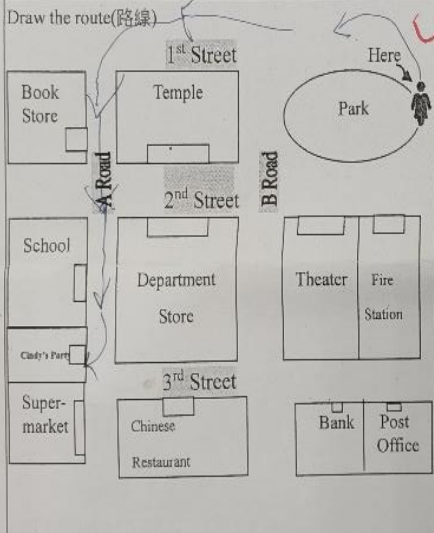

Now you're at the park, and you're asking a man for directions. (You know Cindy's party is between the supermarket and the school.)  
 You: Excuse me. How do I get to the school?  
 Man: Turn left here and walk down 1<sup>st</sup> Street. Go straight for only one block. Then, turn left at the temple. Walk down A Road. Keep going straight. The school is on your right.  
 You can't miss it!  
 You: Thank you very much. ✓

1. Write the places in the blocks (街区). 2. Mark your place with ⊙  
 3. Draw the route. 4. Give directions to your friend, Francis.

restaurant	post office	temple
(I'm here.) School Theater	police office	school
hotel	department	bank

Go straight. ↑ / Turn right. ↗ / Turn left. ↖

My friend, Francis is coming to see me at my place. He is asking me for directions.  
 Francis: How do I go to your place?  
 Me: Where are you?  
 Francis: I'm at the school.  
 Me: Turn left and go straight on A road for one block. And turn right. And walk down 1<sup>st</sup> street keep going straight. And turn right on B road and turn left.  
 And you can see my place. ✓

Unit 5 How Do I Get to Big Ben? Number: 76 Name: Wang

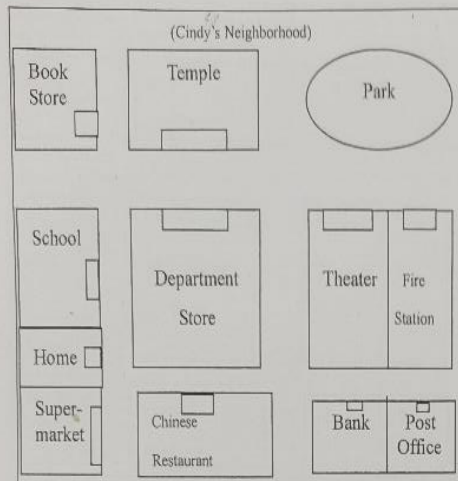

This is Cindy's neighborhood. It's nice and convenient.

There is a big department store across from a temple. There's a bank in back of the restaurant. Next to the bank, there's a post office. In her neighborhood, there is a supermarket. Behind the supermarket, there is a school at the corner. Cindy's house is between the school and the supermarket. There is also a Chinese restaurant near Cindy's house. The food is great.

Please come and visit her neighborhood.

Draw the route (路線)

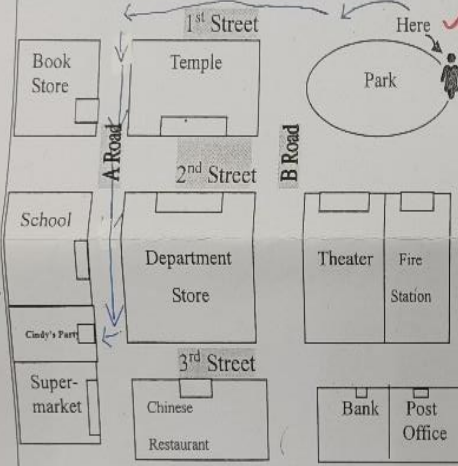

Now you're at the park, and you're asking a man for directions. (You know Cindy's party is between the super-market and the school.)

You: Excuse me. How do I get to the school?

Man: Turn left here and walk down 1st Street. Go

straight or only one block. Then, turn left

at the temple. Walk down A Road. Keep

going straight. The school is on your right.

You can't miss it!

You: Thank you very much.

1. Write the places in the blocks (街区). 2. Mark your place with ⊙

3. Draw the route.

4. Give directions to your friend, Francis.

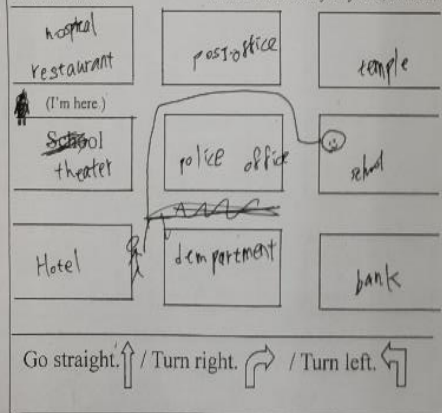

My friend, Francis is coming to see me at my place. He is asking me for directions.

Francis: How can I go to your place?

Me: Where are you?

Francis: I'm at the school.

Me: Turn left and go straight on A Road for one block. And turn right and walk down

1st street keep going straight. And turn right on B Road and turn left.

And you can see my place.

Unit 5 How Do I Get to Big Ben? Number: 71 Name: 朱直涛

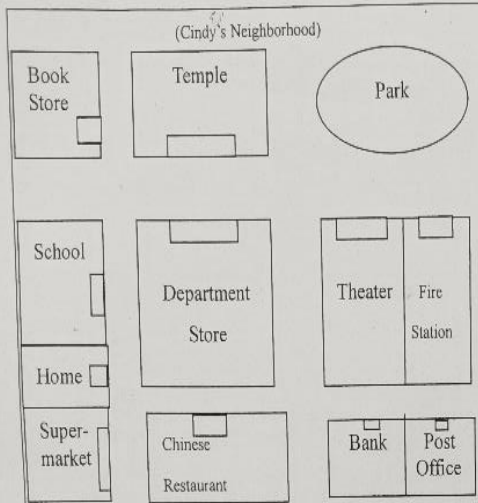

This is Cindy's neighborhood. It's nice and convenient.

There is a big department store across from a temple. There's a bank in back of the theater. Next to the bank, there's a post office. In her neighborhood, there is a supermarket. Behind the supermarket, there is a school on the corner. Cindy's house is between the school and the supermarket. There is also a Chinese restaurant near Cindy's house. The food is great.

Please come and visit her neighborhood. ✓

Draw the route (路线)

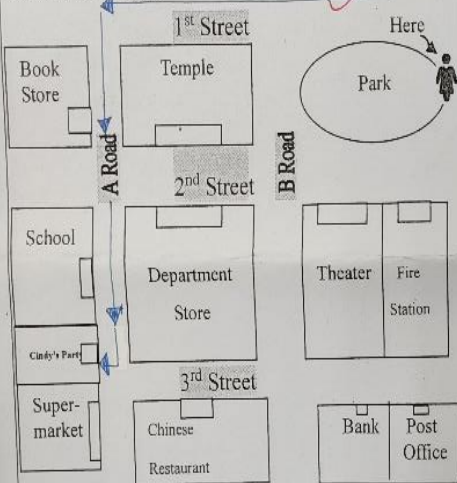

Now you're at the park, and you're asking a man for directions. (You know Cindy's party is between the supermarket and the school.)

You: Excuse me. How do I get to the school?

Man: Turn left here and walk down 1st Street. Go

straight for only one block. Then, turn left

at the temple. Walk down A Road. Keep

going straight. The school is on your right.

You can't miss it! ✓

You: Thank you very much.

- Write the places in the blocks (街区). 2. Mark your place with ⊙
- Draw the route.
- Give directions to your friend, Francis.

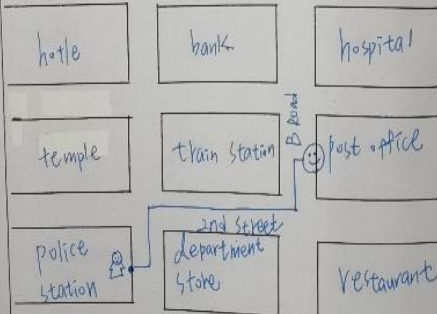

Go straight. ↑ / Turn right. ↗ / Turn left. ↖

My friend, Francis is coming to see me at my place. He is asking me for directions.

Francis: How do I get to your place?

Me: Where are you?

Francis: I'm at the school.

Me: First, turn left and go straight <sup>on</sup> A road.

Then, turn right and go straight <sup>on</sup> 2nd street

After that, turn left and go straight <sup>on</sup>

B2 road for one block, you can <sup>see</sup> find it.

Unit 5 How Do I Get to Big Ben? Number: 10 Name: 陳和豐

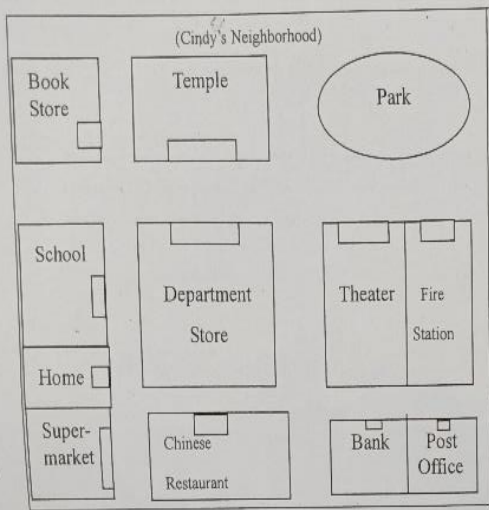

This is Cindy's neighborhood. It's nice and convenient.  
 There is a big department store across from a temple. There's a bank in back of the theater. Next to the bank, there's a post office. In her neighborhood, there is a supermarket. Behind the supermarket, there is a school on the corner. Cindy's house is between the school and the supermarket. There is also a Chinese restaurant near Cindy's house. The food is great.  
 Please come and visit her neighborhood.

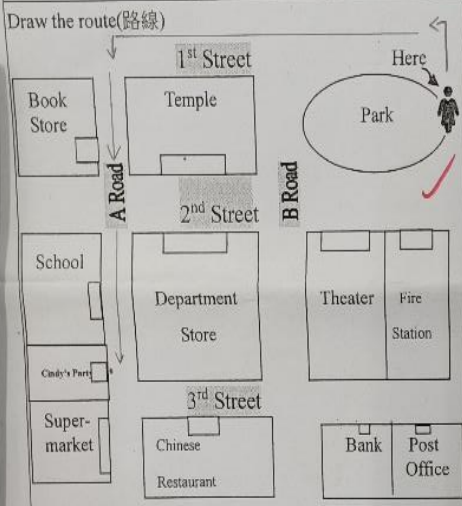

Now you're at the park, and you're asking a man for directions. (You know Cindy's party is between the supermarket and the school.)  
 You: Excuse me. How do I get to the school?  
 Man: Turn left here and walk down 1st Street. Go straight for only one block. Then, turn left at the temple. Walk down A Road. Keep going straight. The school is on your right.  
 You can't miss it!  
 You: Thank you very much.

- Write the places in the blocks (街区). 2. Mark your place with ⊙
- Draw the route.
- Give directions to your friend, Francis.

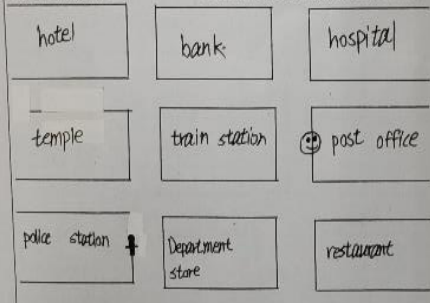

My friend, Francis is coming to see me at my place. He is asking me for directions.  
 Francis: How do I get to your place?  
 Me: Where are you?  
 Francis: I'm at the school.  
 Me: turn left and go straight A road.  
Then, turn right and go straight on 2nd street.  
After that, turn left and go straight A road  
for one block. You can look it.

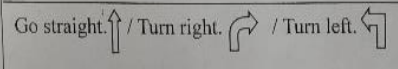

Unit 5 How Do I Get to Big Ben? Number: 40 Name: 李海峰

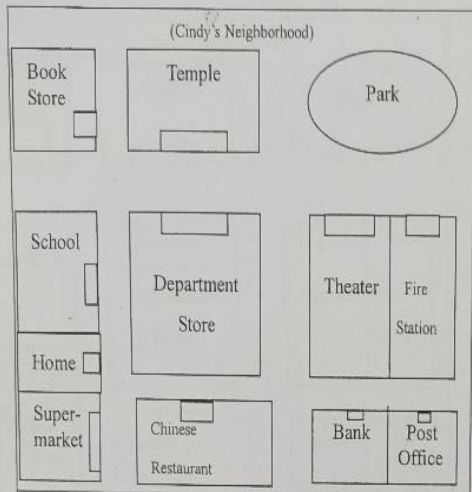

This is Cindy's neighborhood. It's nice and convenient.

There is a big Department store across from a Temple. There's a bank in back of the Theater. Next to the bank, there's a post office. In her neighborhood, there is a supermarket. Behind the supermarket, there is a school on the corner. Cindy's house is home the school and the supermarket. There is also a Chinese restaurant near Cindy's house. The food is great.

Please come and visit her neighborhood.

Draw the route(路線)



Now you're at the park, and you're asking a man for directions. (You know Cindy's party is between the supermarket and the school.)

You: excuse me. How do I get to the school?

Man: Turn left here and walk down 1st Street. Go

straight for only one block. Then, turn left

at the temple. Walk down A Road. Keep

going straight. The school is on your right.

You can't miss it!

You: Thank you very much.

1. Write the places in the blocks(街区). 2. Mark your place with ⊙

3. Draw the route.

4. Give directions to your friend, Francis.



Go straight. ↑ / Turn right. ↻ / Turn left. ↶

My friend, Francis is coming to see me at my

place. He is asking me for directions.

Francis: How do I get to your place?

Me: Where are you?

Francis: I'm at the school.

Me: Turn left and go straight <sup>on</sup> A road.

Then, turn right

turn

Unit 5 How Do I Get to Big Ben? Number: 33 Name: 林邦升

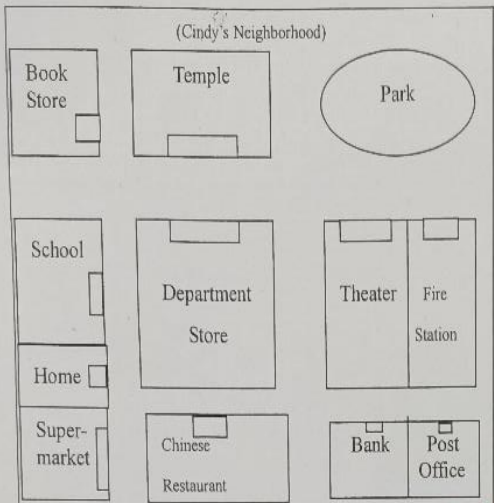

This is Cindy's neighborhood. It's nice and convenient.

There is a big department store across from a temple. There's a bank in back of the theater. Next to the bank, there's a post office. In her neighborhood, there is a supermarket. Behind the supermarket, there is a school on the corner. Cindy's house is between the school and the supermarket. There is also a Chinese restaurant near Cindy's house. The food is great.

Please come and visit her neighborhood.

Draw the route (路線)

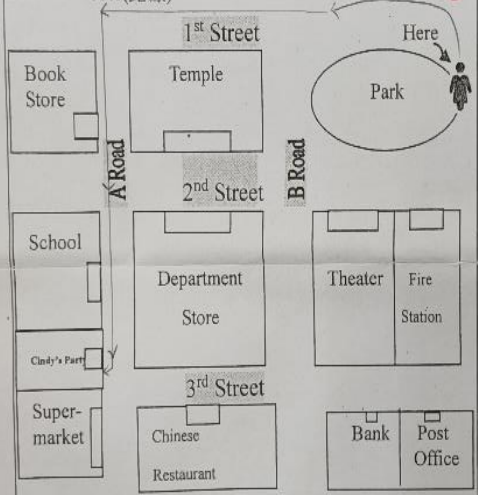

Now you're at the park, and you're asking a man for directions. (You know Cindy's party is between the supermarket and the school.)

You: Excuse me. How do I get to the school?

Man: Turn left here and walk down 1st Street. Go straight for only one block. Then, turn left at the temple. Walk down A Road. Keep going straight. The school is on your right.

You can't miss it!

You: Thank you very much.

- Write the places in the blocks (街区).
- Mark your place with ⊙
- Draw the route.
- Give directions to your friend, Francis.

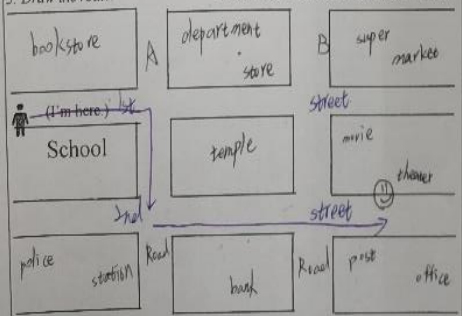

My friend, Francis is coming to see me at my place. He is asking me for directions.

Francis: How do I get to your place?

Me: Where are you?

Francis: I'm at the school.

Me: Go straight a little bit, turn right at the temple, turn right at the school, go straight for one block, you will see my place at your left.

Go straight. ↑ / Turn right. ↘ / Turn left. ↙

# 學生小組作業—學習單\_原尺寸: A3

## Group 1

### Unit 5 How Do I Get to Big Ben?

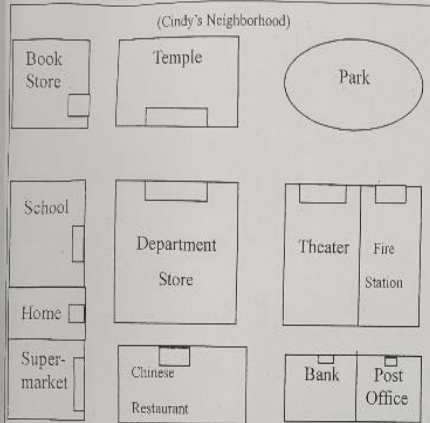

This is Cindy's neighborhood. It's nice and convenient.

There is a big department store across from a temple. There's a bank in back of the theater. Next to the bank, there's a post office. In her neighborhood, there is a supermarket. Behind the supermarket, there is a school on the corner. Cindy's house is between the school and the supermarket. There is also a Chinese restaurant near Cindy's house. The food is great.

Please come and visit her neighborhood.

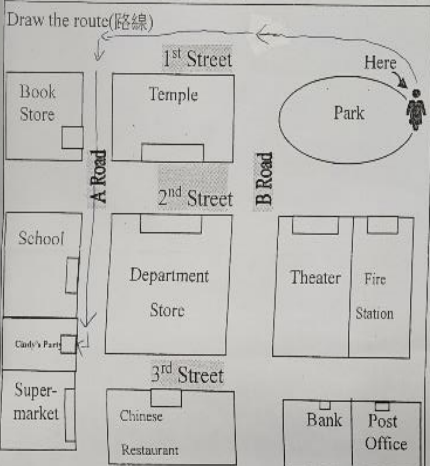

Now you're at the park, and you're asking a man for directions. (You know Cindy's party is between the supermarket and the school.)

You: Excuse me. How do I get to the school?

Man: Turn left here and walk down 1st Street. Go

straight for only one block. Then, turn left

at the temple. Walk down A Road. Keep

going straight. The school is on your right.

You can't miss it!

You: Thank you very much.

1. Write the places in the blocks (街區).
2. Mark your place with ⊙
3. Draw the route.
4. Give directions to your friend, Francis.

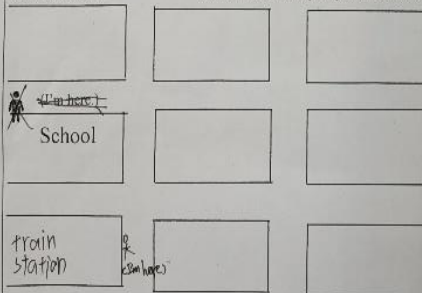

My friend, Francis is coming to see me at my place. He is asking me for directions.

Francis: How do I get to your place?

Me: Where are you?

Francis: I'm at the school.

Me: Go straight for one block and turn right at the department store. Go along 2nd street for one block. It's on your right.

Go straight. ↑ / Turn right. ↘ / Turn left. ↙

# Group 2

## Unit 5 How Do I Get to Big Ben?

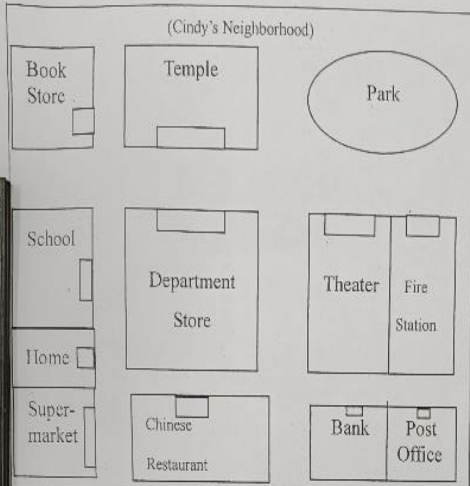

This is Cindy's neighborhood. It's nice and convenient.

There is a big department store across from a supermarket. There's a bank in back of the theater. Next to the bank, there's a post office. In her neighborhood, there is a supermarket. Behind the supermarket, there is a school on the corner. Cindy's house is between the school and the supermarket. There is also a Chinese restaurant near Cindy's house. The food is great.

Please come and visit her neighborhood.

Draw the route(路線)

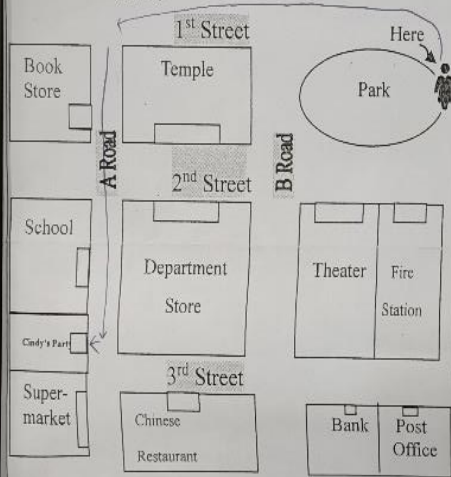

Now you're at the park, and you're asking a man for directions. (You know Cindy's party is between the supermarket and the school.)

You: Excuse me. How do I get to the school?

Man: Turn left here and walk down 1st Street. Go

straight for only one block. Then, turn left at the temple. Walk down A Road. Keep going straight. The school is on your right.

You can't miss it!

You: Thank you very much.

1. Write the places in the blocks (按图). 2. Mark your place with ☺

3. Draw the route.

4. Give directions to your friend, Francis.

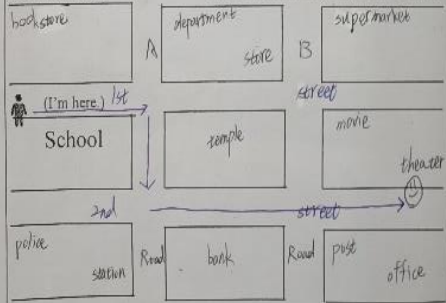

Go straight. ↑ / Turn right. ↻ / Turn left. ↶

My friend, Francis is coming to see me at my place. He is asking me for directions.

Francis: How do I get to \_\_\_\_\_ your place?

Me: Where are you?

Francis: I'm at the school.

Me: Go straight a little bit, turn right at the temple, go straight for one block, and you will see my place at your left.

turn right at 2nd street

# Group 3

## Unit 5 How Do I Get to Big Ben?

(Cindy's Neighborhood)

Book Store	Temple	Park
School	Department Store	Theater Fire Station
Home	Chinese Restaurant	Bank Post Office
Super-market		

Draw the route (路线)

Book Store	Temple	Park
A Road	2 <sup>nd</sup> Street	B Road
School	Department Store	Theater Fire Station
Cindy's Home	Chinese Restaurant	Bank Post Office
3 <sup>rd</sup> Street		

1. Write the places in the blocks (街区). 2. Mark your place with ☺

3. Draw the route. 4. Give directions to your friend, Francis.

(I'm here.) School		

Go straight. ↑ / Turn right. ↘ / Turn left. ↙

This is Cindy's neighborhood. It's nice and convenient.

There is a big department store across from a temple. There's a bank in back of the theater. Next to the bank, there's a post office. In her neighborhood, there is a supermarket. Behind the supermarket, there is a school on the corner. Cindy's house is between the school and the supermarket. There is also a Chinese restaurant near Cindy's house. The food is great.

Please come and visit her neighborhood.

Now you're at the park, and you're asking a man for directions. (You know Cindy's party is between the super-market and the school.)

You: Excuse me. How do I get to the school?

Man: Turn left here and walk down 1<sup>st</sup> Street. Go straight for only one block. Then, turn left at the temple. Walk down A Road. Keep going straight. The school is on your right.

You can't miss it!

You: Thank you very much.

My friend, Francis is coming to see me at my place. He is asking me for directions.

Francis: How can I go to your place?

Me: Where are you?

Francis: I'm at the school.

Me: Turn left and go straight A road for one block. Then turn right and go straight.

1st street keep going straight. And turn right B road and turn left. And you can see my place

# Group 4

## Unit 5 How Do I Get to Big Ben?

(Cindy's Neighborhood)

This is Cindy's neighborhood. It's nice and convenient.

There is a big department store across from a temple. There's a bank in back of the theater. Next to the bank, there's a post office. In her neighborhood, there is a supermarket. Behind the supermarket, there is a school on the corner. Cindy's house is between the school and the supermarket. There is also a Chinese restaurant near Cindy's house. The food is great.

Please come and visit her neighborhood.

Draw the route(路線)

1st Street

2nd Street

3rd Street

A Road

B Road

Here

Now you're at the park, and you're asking a man for directions. (You know Cindy's party is between the supermarket and the school.)

You: Excuse me. How do I get to the school?

Man: Turn left here and walk down 1st Street. Go

straight for only one block. Then, turn left at the temple. Walk down A Road. Keep going straight. The school is on your right.

You can't miss it!

You: Thank you very much.

1. Write the places in the blocks(街区). 2. Mark your place with ☺

3. Draw the route.

4. Give directions to your friend, Francis.

hotel

bank

hospital

temple

train station

post office

police station

department store

restaurant

Go straight. ↑ / Turn right. ↗ / Turn left. ↘

My friend, Francis is coming to see me at my place. He is asking me for directions.

Francis: How do I get to your place?

Me: Where are you?

Francis: I'm at the police station.

Me: Turn left and go straight A road.

Then, turn right and go straight 3rd street.

After that, turn left and go straight B road for one block. You can look it.

# Group 5

## Unit 5 How Do I Get to Big Ben?

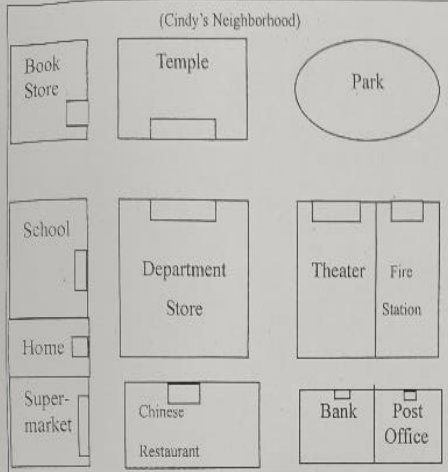

This is Cindy's neighborhood. It's nice and convenient.

There is a big department store across from a temple. There's a bank in back of the theater. Next to the bank, there's a post office. In her neighborhood, there is a supermarket. Behind the supermarket, there is a school on the corner. Cindy's house is between the school and the supermarket. There is also a Chinese restaurant near Cindy's house. The food is great.

Please come and visit her neighborhood.

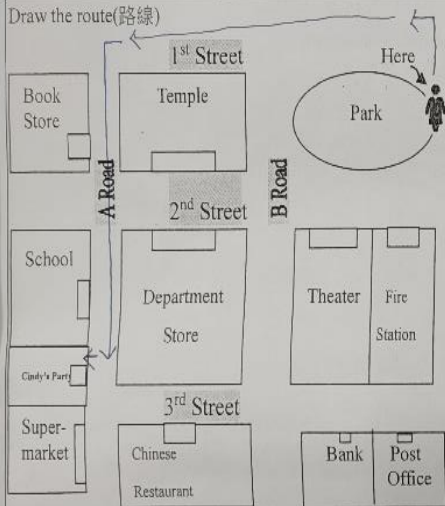

Now you're at the park, and you're asking a man for directions. (You know Cindy's party is between the supermarket and the school.)

You: Excuse me. How do I get to the school?

Man: Turn left here and walk down 1st Street. Go

straight for only one block. Then, turn left

at the temple. Walk down A Road. Keep

going straight. The school is on your right.

You can't miss it!

You: Thank you very much.

1. Write the places in the blocks (街区). 2. Mark your place with ⊙

3. Draw the route.

4. Give directions to your friend, Francis.

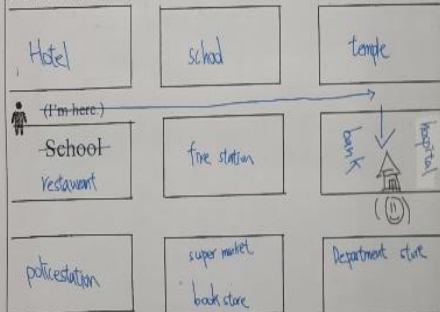

Go straight. ↑ / Turn right. ↻ / Turn left. ↶

My friend, Francis is coming to see me at my

place. He is asking me for directions.

Francis: How do I get to your place?

Me: Where are you?

Francis: I'm at the school.

Me: Go straight on 1st street for one block, turn right at the bank. Walk down on B Road, turn right on 2nd Street. It's between the bank and the hospital.

# Group 6

## Unit 5 How Do I Get to Big Ben?

(Cindy's Neighborhood)

This is Cindy's neighborhood. It's nice and convenient.

There is a big department store across from a temple. There's a bank in back of the theater. Next to the bank, there's a post office. In her neighborhood, there is a supermarket. Behind the supermarket, there is a school on the corner. Cindy's house is between the school and the supermarket. There is also a Chinese restaurant near Cindy's house. The food is great.

Please come and visit her neighborhood.

Draw the route(路線)

Now you're at the park, and you're asking a man for directions. (You know Cindy's party is between the supermarket and the school.)

You: Excuse me. How do I get to the school?

Man: Turn left here and walk down 1st Street. Go

straight for only one block. Then, turn left

at the temple. Walk down A Road. Keep going straight. The school is on your right.

You can't miss it!

You: Thank you very much.

1. Write the places in the blocks(街区). 2. Mark your place with ⊙

3. Draw the route.

4. Give directions to your friend, Francis.

My friend, Francis is coming to see me at my place. He is asking me for directions.

Francis: How do I get to your place?

Me: where are you?

Francis: I'm at the school.

Me: Turn left <sup>at the</sup> book store. Go straight for one block. The bank is on your right.

Go straight. ↑ / Turn right. ↻ / Turn left. ↶

學生小組作業—海報\_原尺寸: 全開

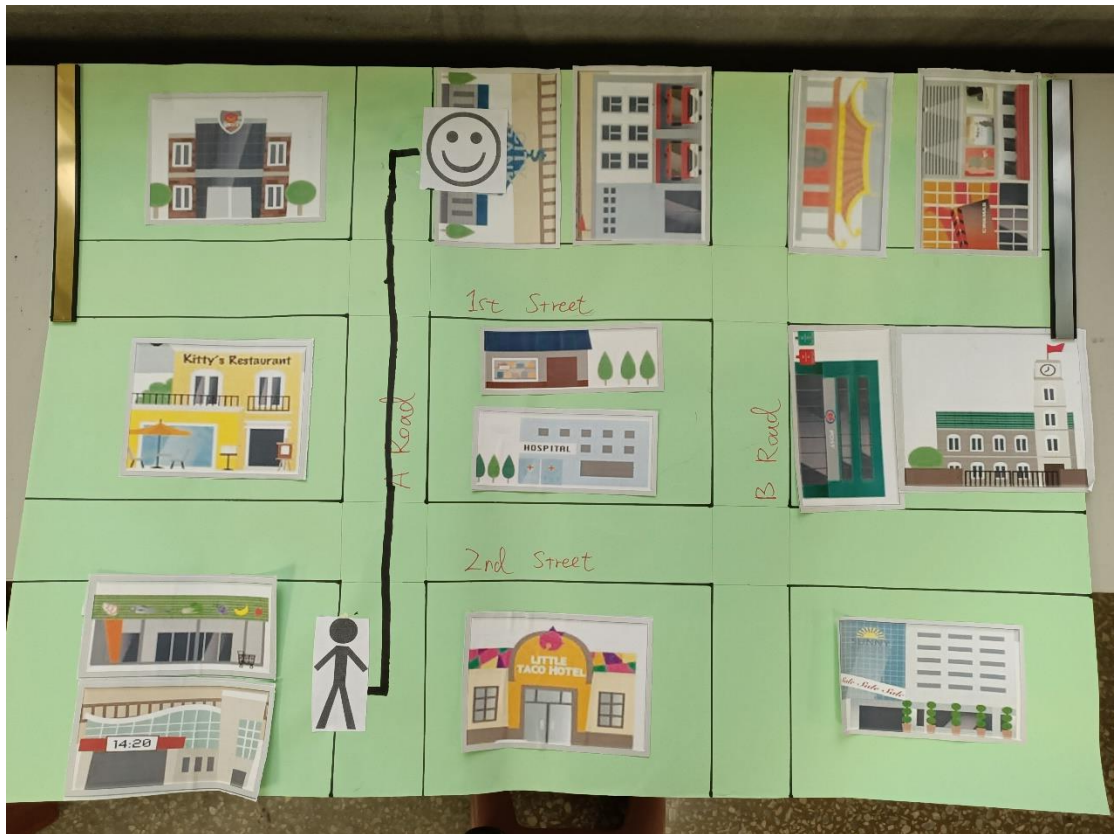

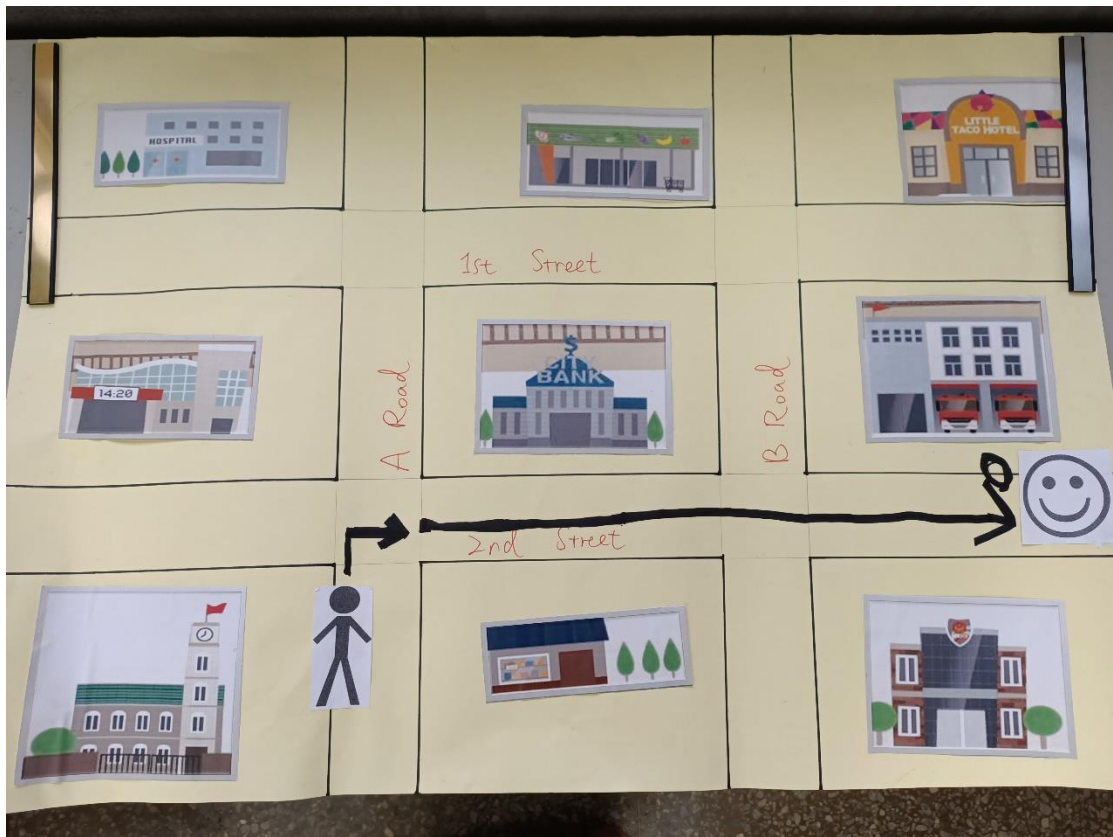
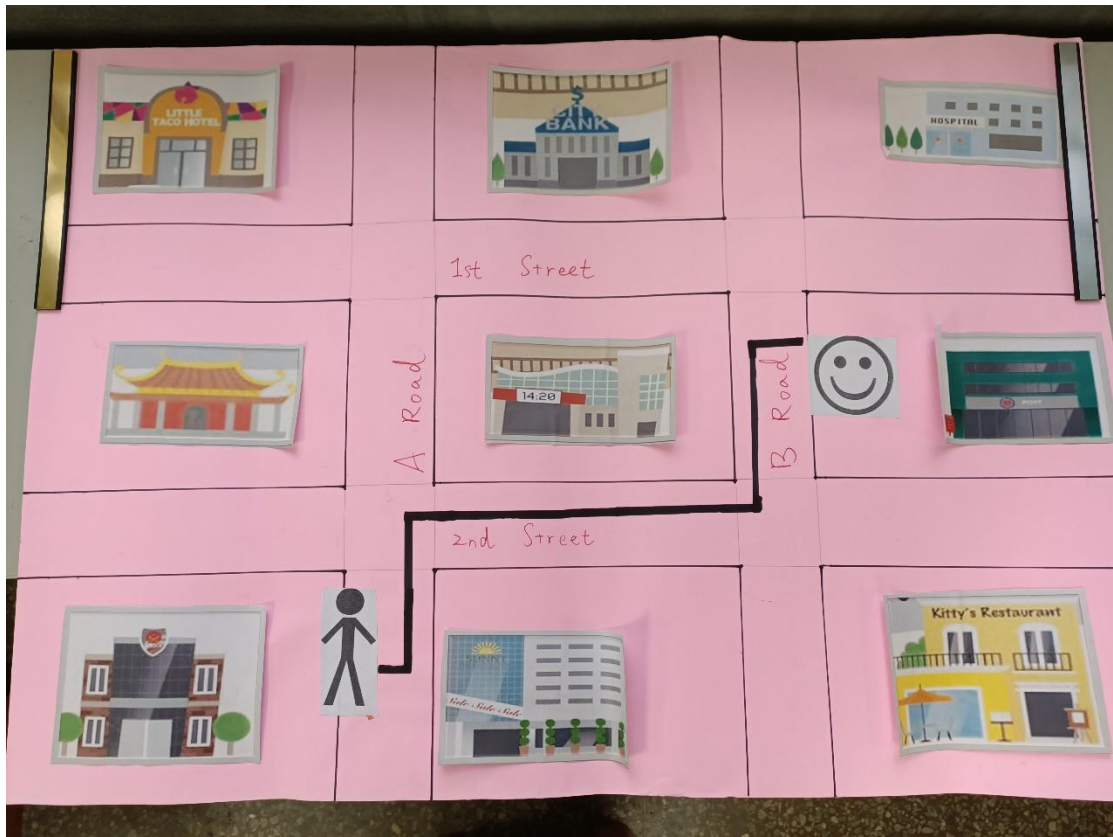

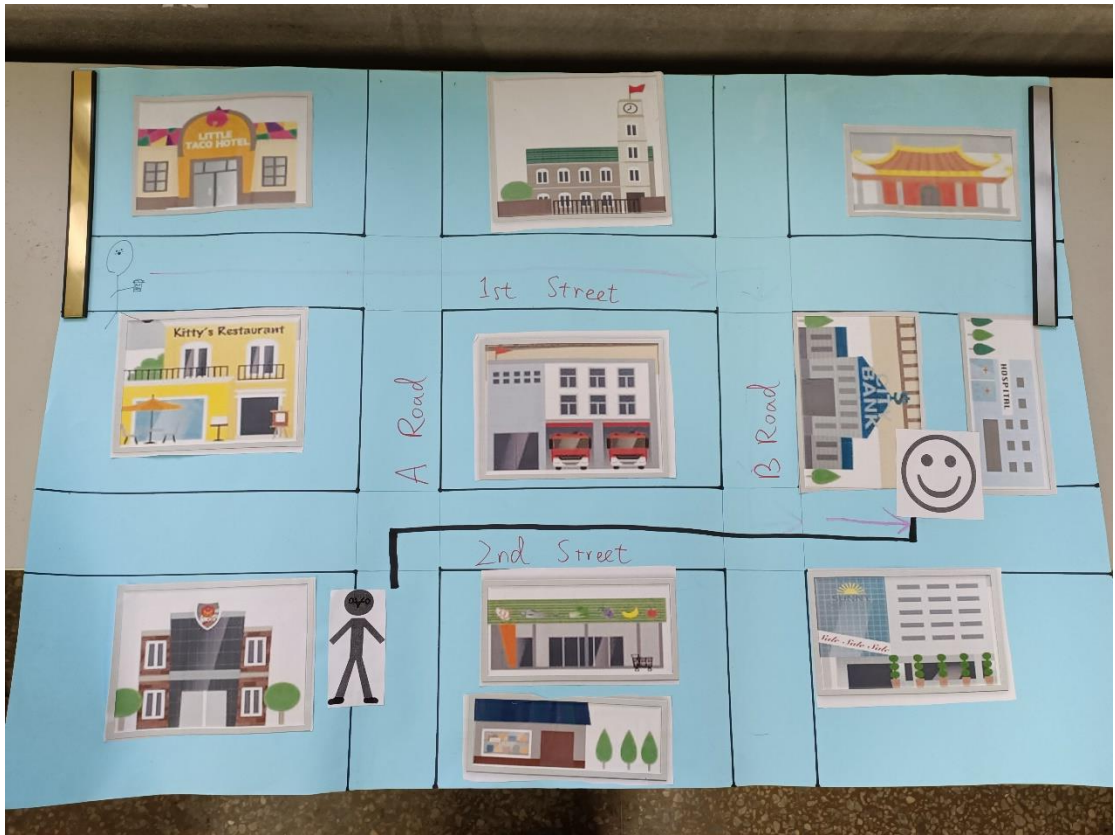
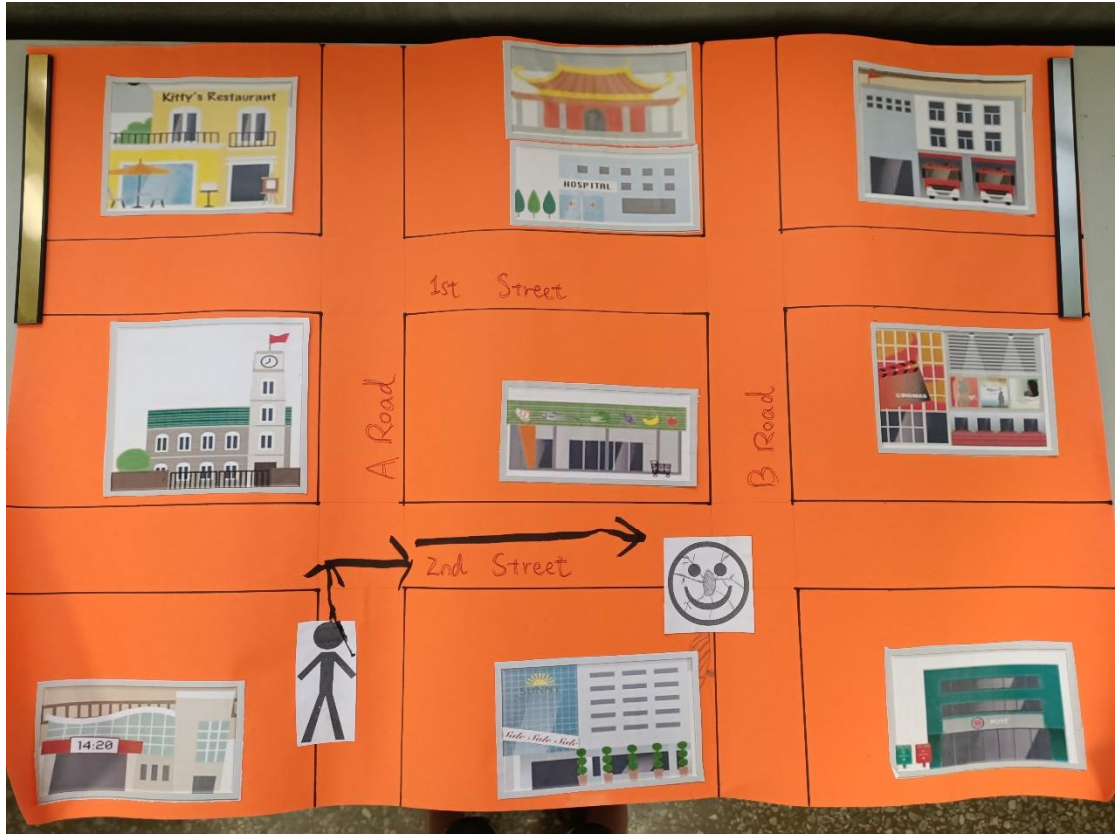



## 學生小組口頭報告







